

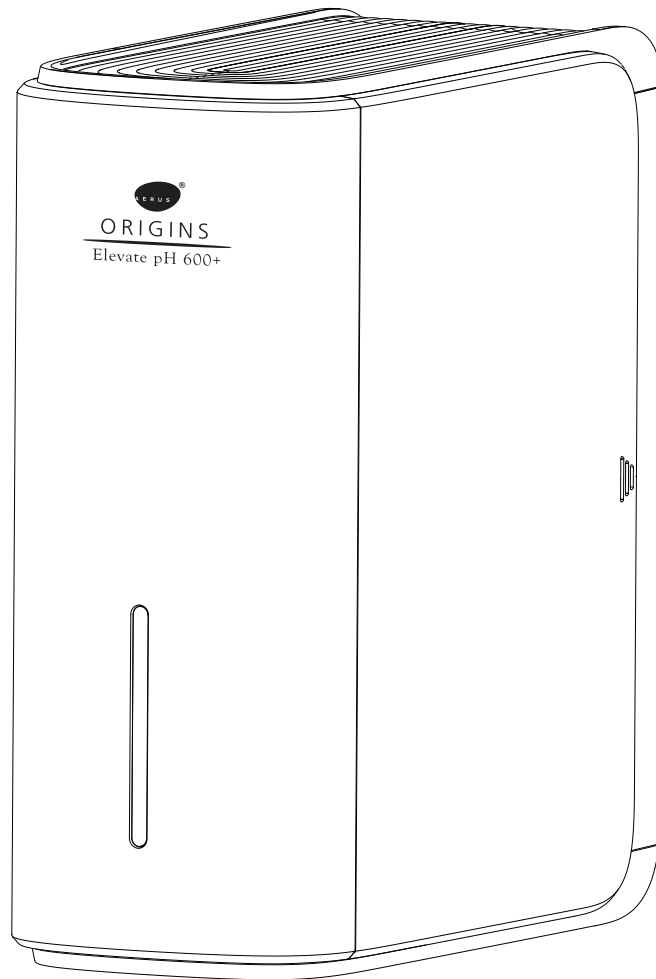

ORIGINS

Elevate pH 600+



Reverse Osmosis Drinking Water System

READ MANUAL CAREFULLY FOR PROPER USE AND OPTIMAL OPERATION.

GENERAL INFORMATION

PRODUCT OVERVIEW

The Aerus Elevate pH600+ Reverse Osmosis Drinking Water System incorporates 6 total stages of treatment. First, the water passes through sediment pre-filtration, then two stages of activated carbon. Then, the NSF approved reverse osmosis membrane removes impurities in the form of organics and/or dissolved solids. The final two polishing stages are of activated carbon, removing all traces of any lingering tastes or odors. An optional alkaline stage is available, and can be substituted for one of the carbon post filters. This pH enhancing step will raise the alkalinity to a much higher level, providing re-mineralization for enhanced hydration.

CONTENTS

Product Overview	2
Specifications	2
Important Safety Instructions	3
Package Contents	4
Installation Diagram	5
Installation Instructions	6
Precautions Before Use	7
Filter Replacement	7-8
Water Treatment Process Diagram	9
Warranty Information	10

FILL IN AND SAVE

Record information regarding your new Aerus Elevate pH600+ here. Retain for future reference.

Model No. _____

Serial No. _____

Date of Purchase _____

Independent Distributor/Contractor:

Name _____

Phone No. _____

Address _____

SPECIFICATIONS

Aerus® Elevate pH600+

- Sales Number: 00753
- Model Number: W210B

Purified Water Flow:

- 0.6L/min @ 50psi

Source Water Quality:

- Municipal water

Source Water Temperature:

- 34° – 86° F (3° – 30° C)

Source Water TDS:

- ≤ 250ppm

Source Water Chlorine Level:

- 4ppm max

Rejection:

- 90-99%

Source Water Pressure:

- Min 40psi (0.27 Mpa)

Tank Capacity:

- 3.2 gallons (12.1 L)

Weight & Dimensions:

- 16.4 lbs with accessories (7.4 kg)
- 17.25" H x 7.25" W x 15.5" D (43.8 cm x 18.4 cm x 39.3 cm)

Operating Temperature:

- 34°F – 100°F (1.6°C – 38°C)

Warranty:

- Limited 3 year warranty on device;
- 1 year warranty on consumables

Aerus, LLC reserves the right to change or modify any specification without notice.

If you have any questions regarding the use of this, or any Aerus product, contact your Independent Distributor/Contractor or Aerus Customer Service at 800.243.9078 (U.S.) or 800.668.0763 (CANADA).

IMPORTANT SAFETY INSTRUCTIONS



CAUTION

- This system is intended for use on potable water supplies or disinfected water containing cysts. Do not use where water is microbiologically unsafe or with water of unknown quality. If bacterial contamination is present, a recognized method of water disinfection is required.
- The Aerus® Elevate pH 600+ Water Purification System contains a replaceable reverse osmosis membrane filter which is critical for the effective reduction of Total Dissolved Solids. The filtered water should be tested periodically to verify that the system is performing properly.

Read this manual in its entirety before using your Aerus Elevate pH600+

- **DO NOT** use System on untreated well water that is microbiologically unsafe
- **DO NOT** exceed 100 psi (0.69 Mpa) water pressure
- **DO NOT** exceed 86°F (30°C) water temperature
- **DO NOT** subject System to freezing conditions
- All plumbing must be in compliance with local and state plumbing codes
- Inspect all plumbing connections; check for leaks and make repairs as needed

SAVE THESE INSTRUCTIONS

PACKAGE CONTENTS

MAIN BODY

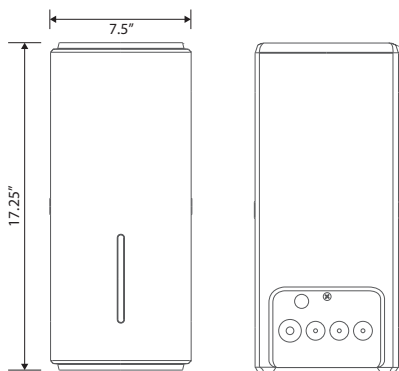

SIX FILTER CARTRIDGES

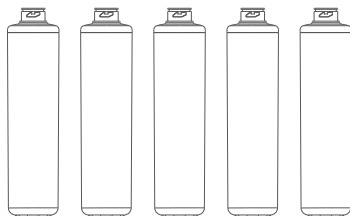

Includes sediment filter (1)
carbon pre-filters (2); reverse
osmosis membrane (1); and
carbon post filters (2). An alkaline
post filter cartridge is optional.

WATER TANK

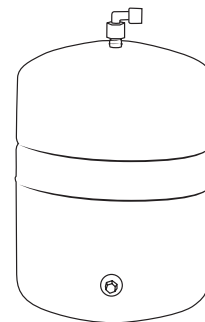

5-7 psi

FITTING ACCESSORIES

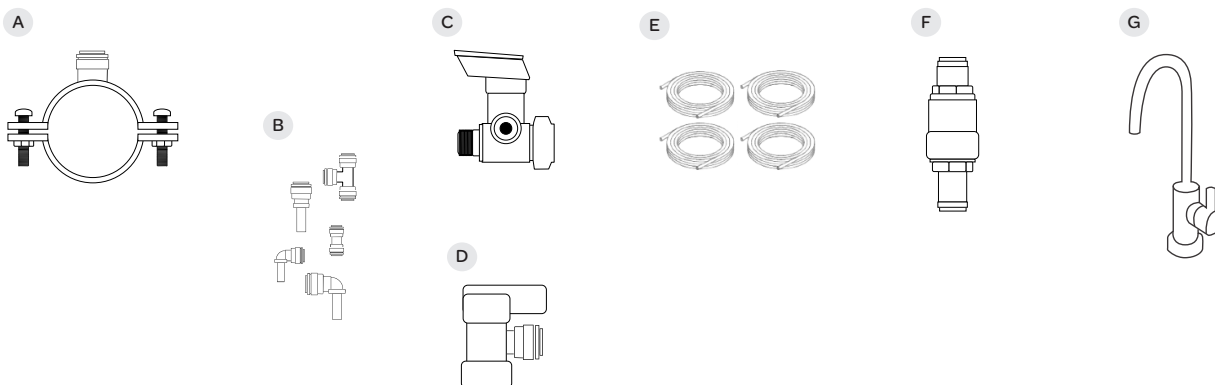

A. Drain Saddle

B. Tubing Fittings: 1/4" Stem Elbow (1)
3/8" Stem Elbows (3)
1/4" Union (1)
3/8" Tee (1)
3/8 x 1/4 Reducer (1)

C. Angle Stop Supply Valve

D. Storage Tank Shut Off Valve

E. Tubing: 1/4" (1)
3/8" (3)

F. In-Line PRV, Not included. Order separately.

G. RO Faucet, Not included. Order separately.

INSTALLATION DIAGRAM

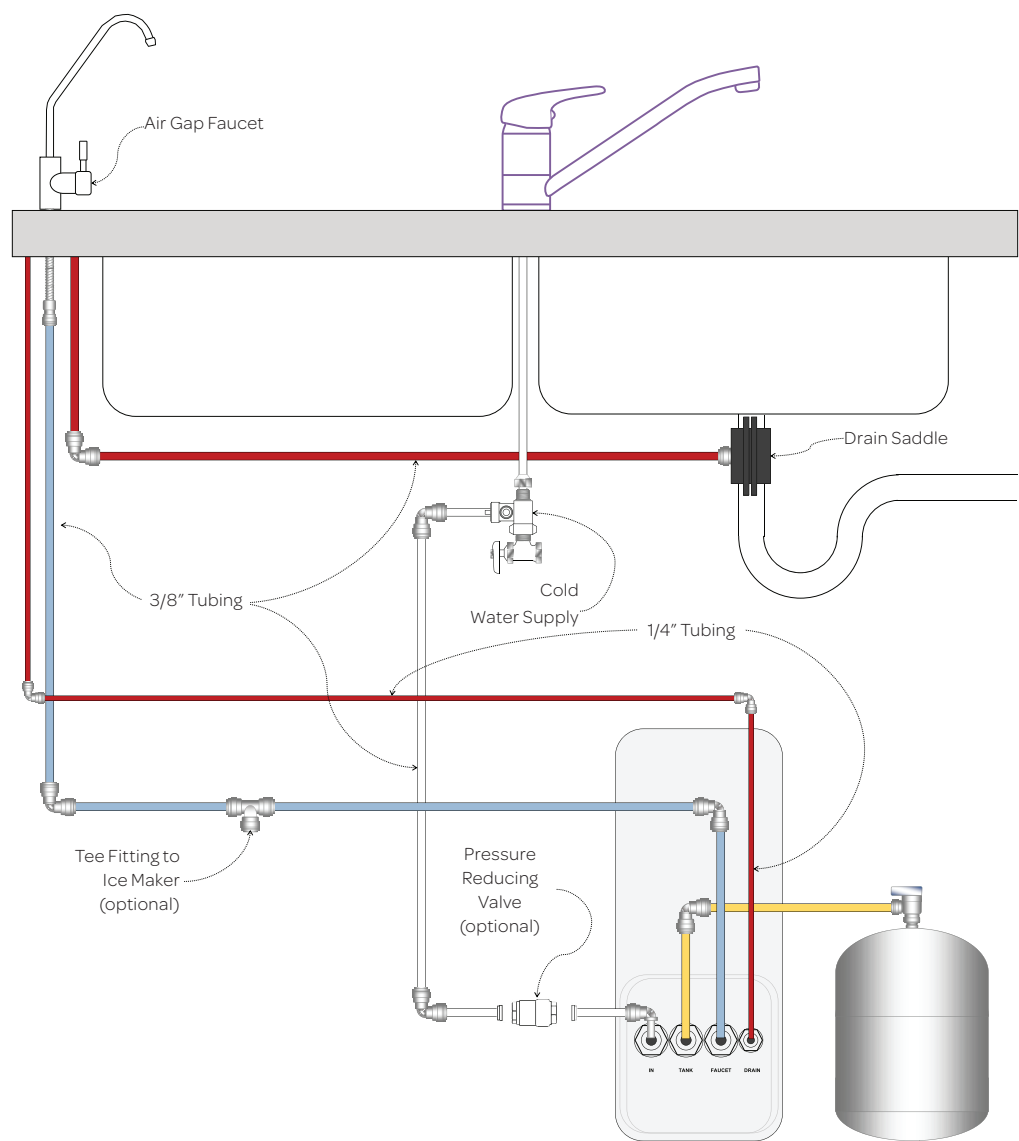

PLUMBING CONNECTIONS

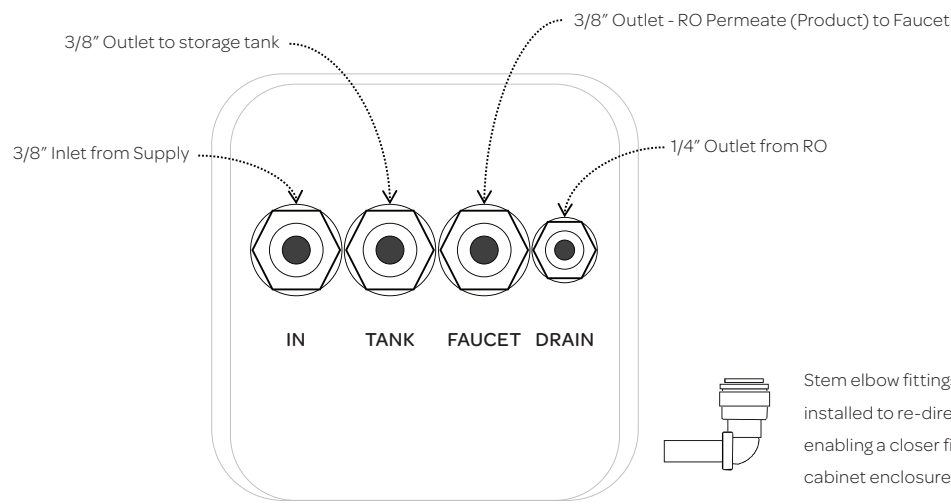

INSTALLATION INSTRUCTIONS



- If countertop is granite, it is strongly recommended that drilling is performed by a professional
- Check local codes on proper drain connection
- When cutting the tubing, make it clean, square cuts; failing to do so result in poor connection and possible leaks
- The lowest point of the line should be the point of connection to the Drain Clamp
- There should be no sag in the line as this may cause excessive noise as the reject water is flowing to drain

STEP 1 – FEED VALVE INSTALLATION

- Turn off cold water supply either at the main or angle stop
- Install feed valve (per diagram) between angle stop and faucet hose
- Connect 3/8" tubing from RO Feed Port
- Valve Feed Valve closed and turn water supply back on

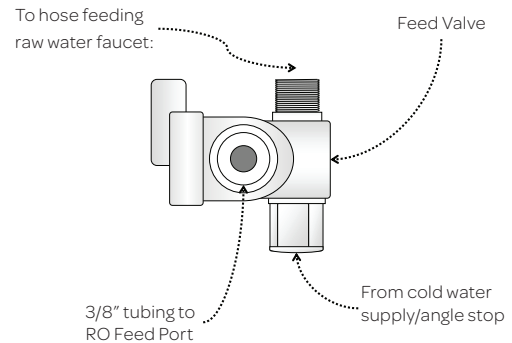

STEP 2 – FAUCET INSTALLATION

- Select a convenient location near the sink to place faucet
- Drill a hole in the selected location (hole size can vary depending on the faucet brand, and whether or not it is equipped with an air gap)
- Place faucet, and install gaskets, plates, washers, and nut as illustrated (air gap faucet hardware can vary)
- Connect 3/8" tubing from RO Faucet/Product Port to center threaded stem, and if air gap equipped, connect 1/4" and 3/8" drain lines as illustrated

Typical Air Gap Faucet Diagram

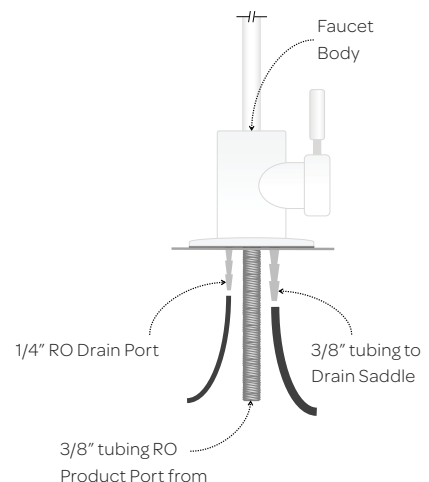

Typical Non-Air

Gap Faucet Diagram

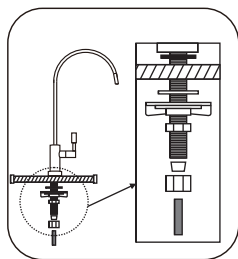

NOTE: Typical connection configuration can vary.

STEP 3 – DRAIN SADDLE INSTALLATION

- Locate drain saddle on drain pipe above the "P" trap and tighten securely
- Remove the collet and o-ring from the drain saddle fitting, and use the hole as a guide to locate and drill a 1/4" hole in the drain pipe (**DO NOT** drill through both sides)
- Replace the o-ring and collet, and insert the 3/8" tubing from the air gap device (if necessary to reduce to 1/4" drain tubing, a stem reducer fitting is supplied)

IMPORTANT:

- Check all local plumbing codes to ensure proper drain connection
- If connecting drain line to a dishwasher drain adaptor, elevate the drain line to ensure that drain flow from the RO does not backflow into the dishwasher

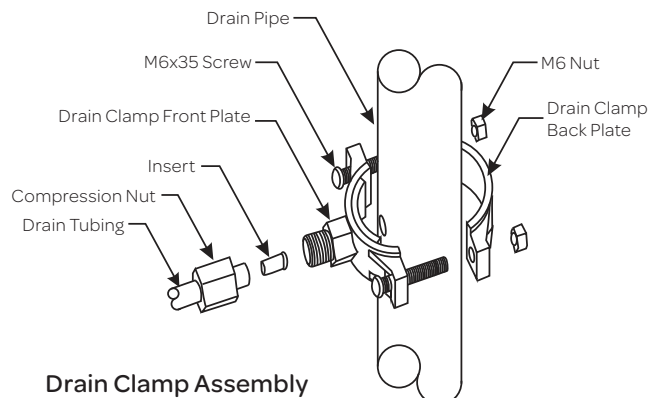

Drain Clamp Assembly

NOTE: Drain saddle illustration is typical, connection configuration can vary.

PRECAUTIONS BEFORE USE



- Replace filters regularly
- Do not disassemble parts randomly, it may cause leakage or damage
- Do not store in an environment of 32 °F (0 °C) or below

SYSTEM PLACEMENT

The RO System can be operated in a horizontal (laying down) position. However, before being placed into service in that position (upon start-up or after Filter replacement), all air must be purged while in a vertical position.

REMINDERS

- Turn off source water immediately if troubles occur and call an Authorized Aerus Representative or Customer Service
- Before turning on the source water, make sure the Aerus Elevate pH 600+ Water Purification System is fully installed and operating correctly
- Run water through the Aerus Elevate pH 600+ Water Purification System for 10 to 15 minutes before drinking the water
- Let the Aerus Elevate pH 600+ Water Purification System operate normally for over 90 minutes before testing the water

FILTER REPLACEMENT

RECOMMENDED REPLACEMENT PERIOD FOR FILTERS

Stages	Cartridge	Function	Estimated Life (Reference only)
First	Sediment P/N: 50079	Polypropylene filter for removal of sand, silt, dirt and rust particles.	6 months
Second	Carbon Block P/N: 50080	Removes suspended particles, organics, and chlorine	6 months
Third	Activated Carbon P/N: 50081	Reduces remaining chlorine by-products	6 months
Fourth	Reverse Osmosis Membrane P/N: 50082	Reduces up to 99% of total dissolved solids and organics	24 months
Fifth	Activated Carbon (standard) P/N: 50081	Polishes product water leaving gas permeable RO membrane	6 months
	Alkaline (optional) P/N: 50083	Greatly elevates pH of product water, enhancing hydration	6 months
Sixth	Polishing Carbon P/N: 50081	Coconut carbon removes any taste or odor from storage tank	6 months

To order replacement parts, contact your Independent Distributor/Contractor or
Aerus® Customer Service at 800.572.0502 (U.S.) or 800.668.0763 (CANADA).

FILTER REPLACEMENT (CONTINUED)



CAUTION

Shut off the source water before replacing the filters.

FILTER REPLACEMENT INSTRUCTIONS

REMINDER: When replacing filters, match the color on the filter label with the color label placed below the filter.

1. Remove the side panel.

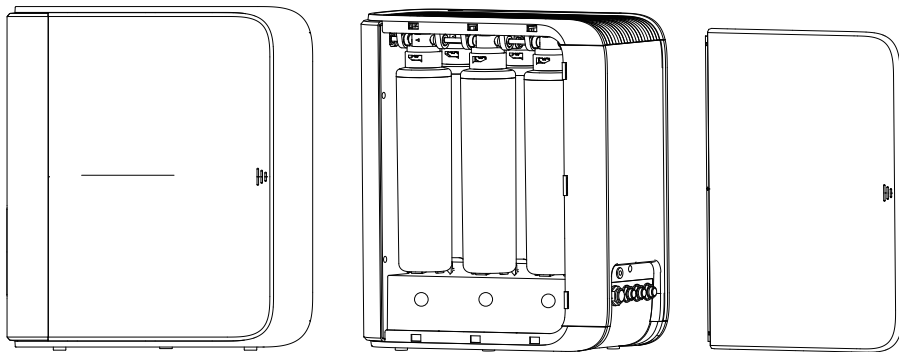

2. Lift up the filter 30°, rotate counterclockwise, then pull down and remove the filter.

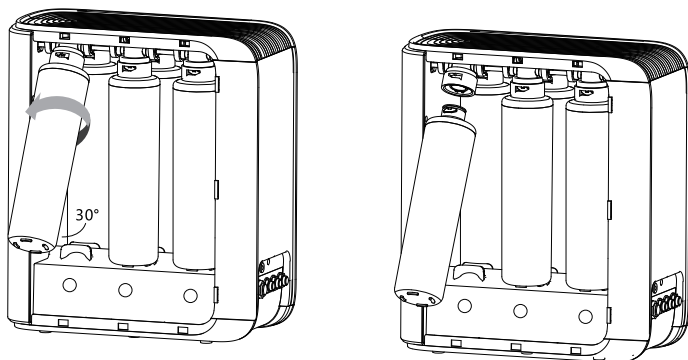

3. Install new filter by pushing up into header bar and rotating clockwise according to specifications. Re-attach the side board panel.

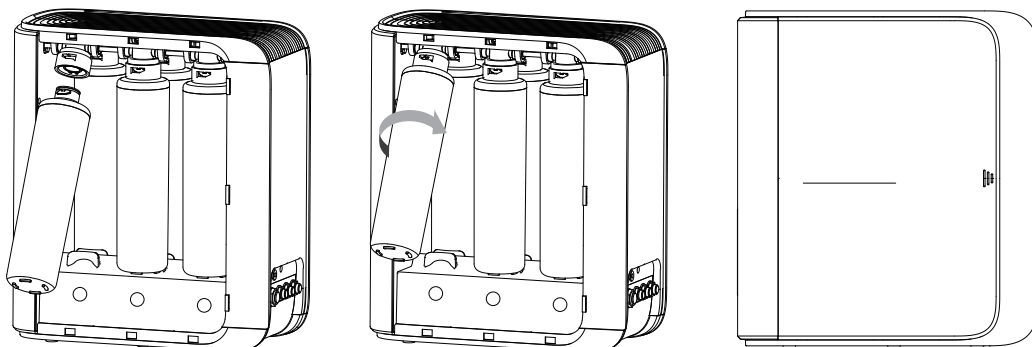

WATER TREATMENT PROCESS DIAGRAM

TECHNOLOGICAL PROCESS

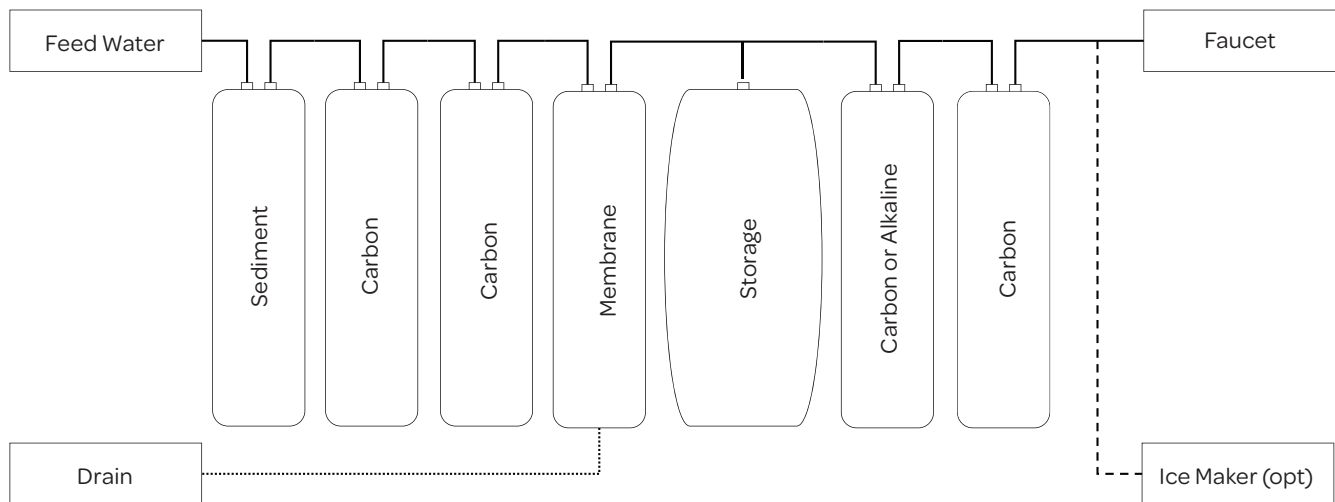

PLUMBING CONNECTIONS

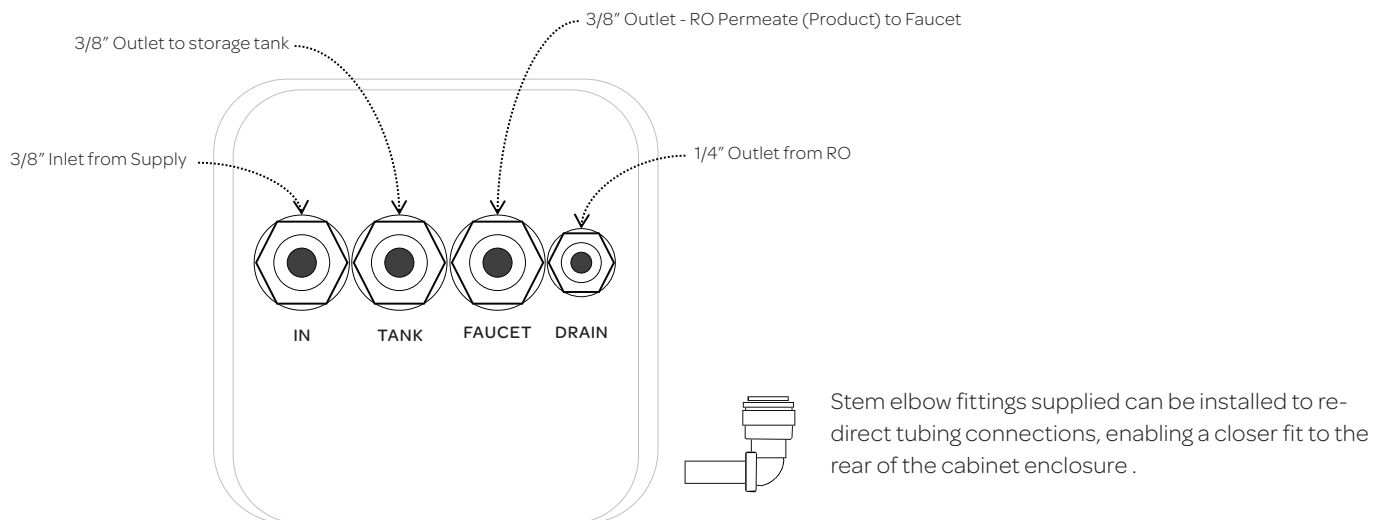

INSTALLATION PROBLEMS?

Every effort is made to ensure customers receive an up-to-date instructions manual on the use of our products; however from time to time, modifications to our products may without notice make the information contained herein subject to alteration. For the latest information, please visit our website.

If you experience installation problems, read the manual first to make sure you have installed the unit correctly. Call Customer Service at 800.243.9078 (U.S.) or 800.668.0763 (Canada) for more information.

WARRANTY INFORMATION

Limited Three (3) Year Warranty

Customer should not repackage and ship the Aerus Elevate pH 600+ Water Purification System because irreparable damage can occur. For warranty service, please contact your Authorized Aerus Representative or Aerus Customer Service at 800.243.9078 (US) or 800.688.0763 (Canada) or register online at www.aerusonline.com/warranty.

WHAT IS COVERED BY THIS WARRANTY

We warrant the Aerus Elevate pH600+ Water Purification System to the consumer, subject to the conditions below, against defects in workmanship or material, provided that the products are returned to an Aerus location within the following time periods:

- The Aerus Elevate pH 600+ Water Purification System (excluding replaceable filters and RO membrane) within 3 years of date of purchase

INSTALLATION AND MAINTENANCE REQUIREMENTS

This warranty is expressly conditioned upon the following installation and maintenance requirements: (i) the Aerus Elevate pH 600+ Water Purification System must be installed by a licensed professional; (ii) the Aerus Elevate pH 600+ Water Purification System must be installed in accordance with National, State & local plumbing codes and the Owner's Manual; (iii) all filters and RO membrane must be replaced at the intervals prescribed in the Owner's Manual (proof of filter change may be required) and (iv) the Aerus Elevate pH 600+ Water Purification System must be used and maintained in accordance with the Owner's Manual. Failure to meet any of these requirements will void this warranty. Servicing your Aerus Elevate pH 600+ Water Purification System by parties other than an Authorized Aerus Representative and/or using parts other than genuine Aerus parts will also void this warranty.

HOW TO OBTAIN WARRANTY SERVICE

Customer must contact Aerus Customer Service or go online to www.aerusonline.com/site/warrantyform to activate their warranty within 1-year of purchase. We will repair or replace and return the product, without charge and within a reasonable period of time, subject to the conditions in the above paragraphs, if its examination shall disclose any part to be defective in workmanship or material. If we, in our discretion, are unable to repair the product after a reasonable number of attempts, we will provide either a refund of the purchase price or a replacement unit, at the company's option.

WHAT IS NOT COVERED BY THIS WARRANTY

This product is intended for household use only. Ordinary wear and tear shall not be considered a defect in workmanship or material. These warranties do not apply for loss or damage caused by accident, fire, abuse, misuse, improper installation, leaking, modification, misapplication, delivery, commercial use, use of product where water is microbiologically unsafe or of unknown quality without proper disinfection, or by any repairs other than those provided by an authorized Aerus Service Center. This warranty does not cover any water damage or costs of installation.

MISSING SERIAL NUMBERS AND UNAUTHORIZED CHANNELS

If a valid serial number is missing from the product, the warranty will be voided. Warranties are voided if a product is purchased through unauthorized channels, this includes websites that are not authorized to sell our products OR to use Aerus trademarked names, images and logos as well as Internet auction sites (e.g. ebay and Craigslist). The only approved Internet presence for Aerus products is www.aerusonline.com. To confirm warranty coverage prior to purchasing a product, contact Aerus Customer Service at 800.243.9078 (U.S.) or 800.688.0763 (CANADA) with the serial number located on the back of the unit.

EXCLUSION OF OTHER WARRANTIES AND CONDITIONS

EXCEPT AS PROVIDED HEREIN, AND TO THE EXTENT CONSISTENT WITH APPLICABLE LAWS, WE MAKE NO REPRESENTATION OR WARRANTY OF ANY KIND. ALL OTHER WARRANTIES OF ANY KIND, EXPRESS OR IMPLIED, ARE HEREBY EXPRESSLY DISCLAIMED, INCLUDING ANY IMPLIED WARRANTY OF MERCHANTABILITY OR FITNESS FOR A PARTICULAR PURPOSE.

LIMITATION OF LIABILITY FOR SPECIAL, INCIDENTAL, OR CONSEQUENTIAL DAMAGES

TO THE EXTENT CONSISTENT WITH APPLICABLE LAWS, WE SHALL NOT IN ANY CASE BE LIABLE FOR SPECIAL, INCIDENTAL OR CONSEQUENTIAL DAMAGES ARISING FROM BREACH OF EXPRESSED OR IMPLIED WARRANTIES, CONDITIONS, GUARANTEES OR REPRESENTATIONS, BREACH OF CONTRACT, NEGLIGENCE OR ANY OTHER LEGAL THEORY. Such excluded damages include, but are not limited to, loss of profits or revenue, and loss of the use of the products.

FOR U.S. APPLICATION ONLY

This warranty gives you specific legal rights, and you may also have other rights which vary from state to state. Some states do not allow limitations on warranties, or on remedies for breach. In such states, the above limitations may not apply to you.

FOR CANADIAN APPLICATION ONLY

Exclusion of Subsequent Owners: Except as otherwise required by applicable legislation, this warranty is not transferable. This warranty gives you specific legal rights and you may also have other rights which vary from province to province. Some provinces and territories do not allow limitations on warranties, or on remedies for breach. In such provinces or territories, the above limitations may not apply to you. If any provision of this warranty or part thereof is held by a court of competent jurisdiction to be invalid, illegal, or unenforceable, the validity, legality and enforceability of the remaining provisions or parts thereof will not in any way be affected or impaired within the jurisdiction of that court. This entire warranty shall continue to be valid, legal and enforceable in any jurisdiction where a similar determination has not been made.

This warranty is provided by:
Aerus, LLC
1300 Valley Drive
Bristol, VA 24201

SERVICE

Every effort is made to ensure customers receive an up-to-date instructions manual on the use of our products; however, from time to time, modifications to our products may without notice make the information contained herein subject to alteration. For the latest information, please call Customer Service at 800.243.9078 (US) or 800.688.0763 (Canada), or visit our website at www.aerusonline.com.

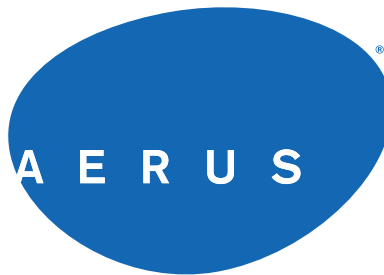

For information regarding the use of this product please contact Customer Service

800.243.9078 (U.S.)
800.668.0763 (CANADA)

www.aerusonline.com

Aerus, LLC | 1300 Valley Drive | Bristol, VA 24201 | 800.243.9078
Aerus Canada, Inc. | 3480 Laird Road, Suite 2-5 | Mississauga, ON L5L 5Y4 | 800.668.0763

© Aerus, LLC. All Rights Reserved

EPH6_OM_L00951-2797_EA-04058_1121